



Elmtree Road, Teddington

Modern and Contemporary

Offers in excess of £500,000
Leasehold

Description

This stunning open plan 2 double bedroom ground floor apartment forms part of a gated bespoke development being one of only 7 apartments that were recently converted to a high specification. The large open plan living/dining room offers a sleek kitchen with compac stone worktops, integrated appliances including a dishwasher, beautiful dark oak laminate flooring and flows out to a superb decked terrace and down to a grassed courtyard garden. Ideal for those summer evening bbq's to entertain your friends and family. There are two bedrooms off the central living area and a luxury family bathroom.

Situated in a quiet location just 10-12 minutes walk to Teddington High Street and 12-14 minutes walk to Teddington Station. Inviting buyers who are looking between £500,000 to £550,000-Buyer Search Ranch.

Location

Teddington High Street offers an eclectic mix of fine dining restaurants and quality gastro pubs. Local schooling for all ages is well catered for with St Mary's & St Peter's, Stanley School, Newlands House, The Mall, Waldegrave Girls and Teddington School to name but a few. Teddington also has the walk-in Memorial Hospital close by. Nearby is Teddington Station, just a 35 minute journey to London Waterloo. The A316/M3 is accessible at Twickenham for easy access to the M3 Heathrow Airport is just a 25-minute drive away.



Leasehold: Lease created in 2017 for 125 years (122 years remaining). Maintenance £2,000 per ann. Ground Rents: £350 per ann

Tenure

Leasehold

Elemtree Road

Approx. Gross Internal Area
61 Sq M - 653 Sq Ft

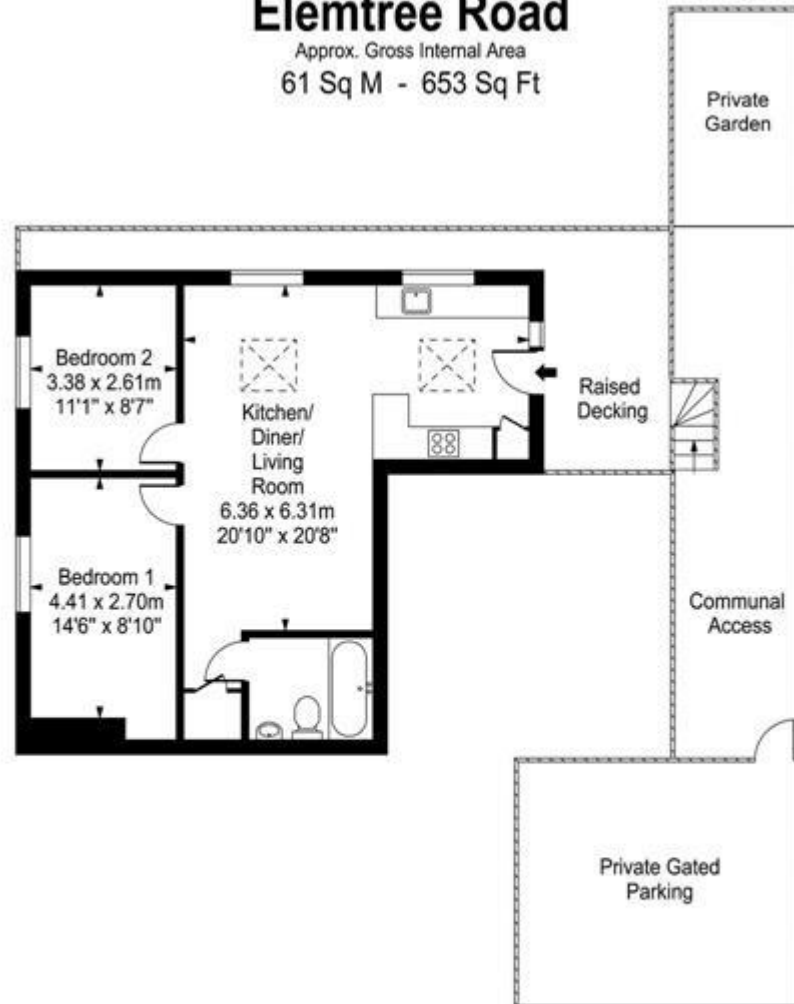

Every attempt is made to assure accuracy, however measurements are approximate and for illustrative purposes only. Not to scale.
Floor plan by www.frameworkphotos.co.uk

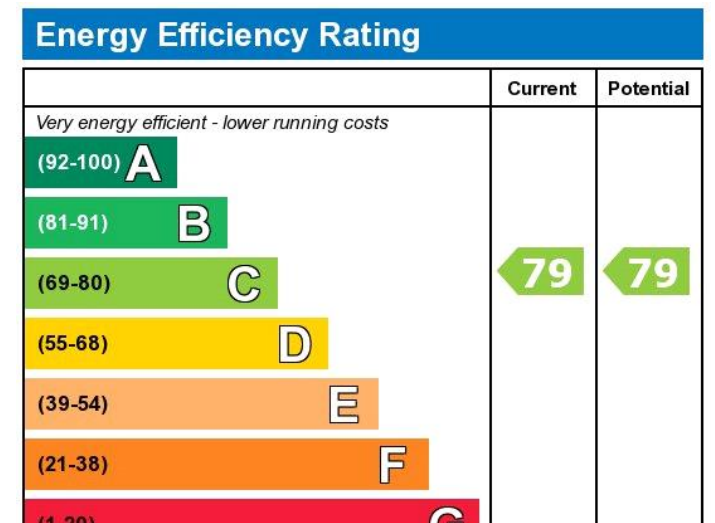

Viewing by appointment only
 Castor Bay Property Ltd - Head Office
 Regal House, 70 London Road, Twickenham TW1 3QS
 Tel: 020 8892 5656 Email: sandra@castorbay.property Website:

